



AVK FLANGED REDUCER

712/2210-001

PN 10/16

AVK's range of fittings comprises a wide selection of variants with socket and flange connection. The fittings are made of ductile iron GJS-500-7 and are epoxy coated according to DIN 30677-2 and GSK specifications - internally and externally.

Product description:

Double flange reducer type FFR to EN 545 for water, waste water and neutral liquids to max. 70° C

Design standards:

- EN 545
- Flange drilling to EN1092, PN10/16

Test/Approvals:

- Approved according to ACS-France
- Belgaqua approved material

Features:

- Ductile iron fitting to EN 545
- Body of GJS-500-7
- Epoxy coated to DIN 3476 and GSK internally and externally

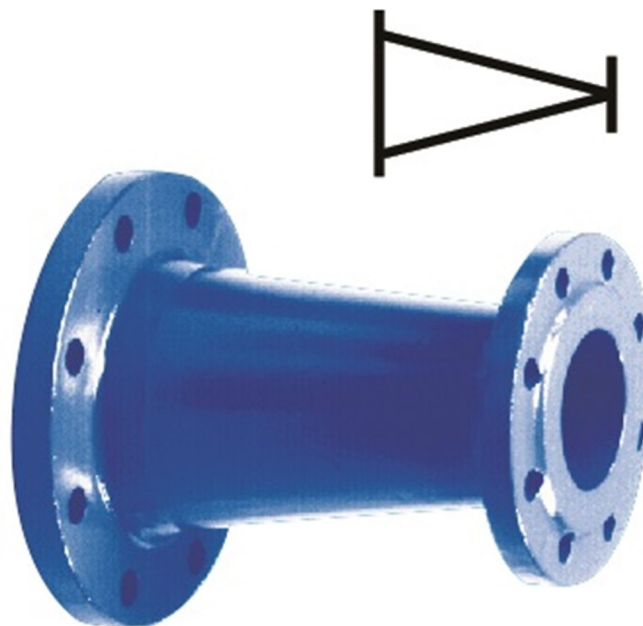

Expect... **AVK**

The designs, materials and specifications shown are subject to change without notice due to the continuous development of our product range.

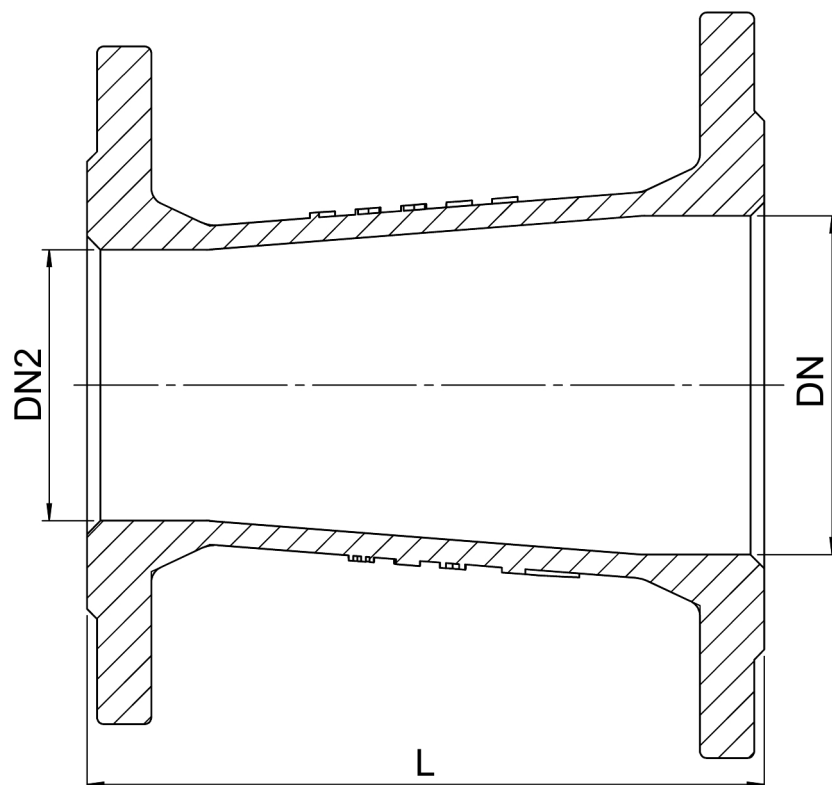
Component list:

1. Fitting	Ductile Iron
------------	--------------

Components may be substituted with equivalent or higher class materials without prior notification.

Reference nos. and dimensions:

AVK ref. no.	DN mm	DN2 mm	Flange drilling	L mm	Theoretical weight/kg
712-0051-22-101	50	40	PN10/16	150	5.8
712-0066-22-101	65	50	PN10/16	200	6.7
712-0067-22-101	65	40	PN10/16	200	6.2
712-0081-22-101	80	65	PN10/16	200	7.8
712-0082-22-101	80	50	PN10/16	200	7.1
712-0083-22-101	80	40	PN10/16	200	6.7
712-0101-22-101	100	80	PN10/16	200	9.1
712-0102-22-101	100	65	PN10/16	200	8.6
712-0103-22-101	100	50	PN10/16	200	7.9
712-0104-22-101	100	40	PN10/16	200	7.4
712-0126-22-101	125	100	PN10/16	200	11
712-0127-22-101	125	80	PN10/16	200	10
712-0128-22-101	125	65	PN10/16	200	9.8
712-0129-22-101	125	50	PN10/16	200	9.2
712-0130-22-101	125	40	PN10/16	200	8.7
712-0151-22-101	150	125	PN10/16	200	14
712-0152-22-101	150	100	PN10/16	200	12
712-0153-22-101	150	80	PN10/16	200	12
712-0154-22-101	150	65	PN10/16	200	11
712-0155-22-101	150	50	PN10/16	341	13
712-0156-22-101	150	40	PN10/16	200	10
712-0201-22-100	200	150	PN10	300	21
712-0201-22-101	200	150	PN16	300	21
712-0202-22-100	200	125	PN10	300	19
712-0202-22-101	200	125	PN16	300	19
712-0203-22-100	200	100	PN10	300	18

The designs, materials and specifications shown are subject to change without notice due to the continuous development of our product range.

AVK FLANGED REDUCER**712/2210-001****PN 10/16****Reference nos. and dimensions:**

AVK ref. no.	DN	DN2	Flange	L	Theoretical weight/kg
	mm	mm	drilling	mm	
712-0203-22-101	200	100	PN16	300	18
712-0204-22-100	200	80	PN10	300	17
712-0204-22-101	200	80	PN16	300	17
712-0205-22-100	200	65	PN10	300	17
712-0205-22-101	200	65	PN16	300	16
712-0206-22-100	200	50	PN10	300	16
712-0206-22-101	200	50	PN16	300	16
712-0207-22-100	200	40	PN10	300	15
712-0207-22-101	200	40	PN16	300	15
712-0251-22-100	250	200	PN10	300	29
712-0251-22-101	250	200	PN16	300	29
712-0252-22-100	250	150	PN10	300	26
712-0252-22-101	250	150	PN16	300	26
712-0253-22-100	250	125	PN10	300	24
712-0253-22-101	250	125	PN16	300	24
712-0254-22-100	250	100	PN10	300	23
712-0254-22-101	250	100	PN16	300	23
712-0301-22-100	300	250	PN10	300	41
712-0301-22-101	300	250	PN16	300	41
712-0302-22-100	300	200	PN10	300	36
712-0302-22-101	300	200	PN16	300	36
712-0303-22-100	300	150	PN10	300	34
712-0303-22-101	300	150	PN16	300	34
712-0305-22-100	300	100	PN10	300	31
712-0305-22-101	300	100	PN16	300	31
712-0349-22-100	350	300	PN10	300	48
712-0349-22-101	350	300	PN16	300	51
712-0352-22-100	350	250	PN10	300	44
712-0352-22-101	350	250	PN16	300	47
712-0353-22-100	350	200	PN10	300	41
712-0353-22-101	350	200	PN16	300	43
712-0354-22-100	350	150	PN10	300	37
712-0354-22-101	350	150	PN16	300	40
712-0355-22-100	350	125	PN10	300	34
712-0355-22-101	350	125	PN16	300	37
712-0356-22-100	350	100	PN10	300	33
712-0356-22-101	350	100	PN16	300	36
712-0401-22-100	400	350	PN10	300	53
712-0401-22-101	400	350	PN16	300	53
712-0402-22-100	400	300	PN10	300	76
712-0402-22-101	400	300	PN16	300	53
712-0403-22-100	400	250	PN10	300	48
712-0403-22-101	400	250	PN16	300	53
712-0404-22-100	400	200	PN10	300	44
712-0404-22-101	400	200	PN16	300	49
712-0405-22-100	400	150	PN10	300	41
712-0405-22-101	400	150	PN16	300	46
712-0406-22-100	400	125	PN10	300	40
712-0406-22-101	400	125	PN16	300	45
712-0407-22-100	400	100	PN10	300	38
712-0407-22-101	400	100	PN16	300	44
712-0451-22-100	450	400	PN10	300	70
712-0451-22-101	450	400	PN16	300	83
712-0452-22-100	450	350	PN10	300	64
712-0452-22-101	450	350	PN16	300	78
712-0453-22-100	450	300	PN10	300	60
712-0453-22-101	450	300	PN16	300	73
712-0454-22-100	450	250	PN10	300	56
712-0454-22-101	450	250	PN16	300	68
712-0455-22-100	450	200	PN10	300	52
712-0455-22-101	450	200	PN16	300	64

The designs, materials and specifications shown are subject to change without notice due to the continuous development of our product range.

AVK FLANGED REDUCER

PN 10/16

712/2210-001

Reference nos. and dimensions:

AVK ref. no.	DN	DN2	Flange	L	Theoretical weight/kg
	mm	mm	drilling	mm	
712-0456-22-100	450	150	PN10	300	49
712-0456-22-101	450	150	PN16	300	61
712-0457-22-100	450	125	PN10	300	48
712-0457-22-101	450	125	PN16	300	60
712-0468-22-100	450	100	PN10	300	47
712-0468-22-101	450	100	PN16	300	59
712-0501-22-100	500	450	PN10	600	114
712-0501-22-101	500	450	PN16	600	140
712-0502-22-100	500	400	PN10	600	107
712-0502-22-101	500	400	PN16	600	129
712-0503-22-100	500	350	PN10	600	101
712-0503-22-101	500	350	PN16	600	119
712-0504-22-100	500	300	PN10	600	92
712-0504-22-101	500	300	PN16	600	109
712-0505-22-100	500	250	PN10	600	84
712-0505-22-101	500	250	PN16	600	99
712-0506-22-100	500	200	PN10	600	78
712-0506-22-101	500	200	PN16	600	93
712-0507-22-100	500	150	PN10	600	73
712-0507-22-101	500	150	PN16	600	88
712-0508-22-100	500	125	PN10	600	71
712-0508-22-101	500	125	PN16	600	86
712-0509-22-100	500	100	PN10	600	69
712-0509-22-101	500	100	PN16	600	84
712-0601-22-100	600	500	PN10	600	149
712-0601-22-101	600	500	PN16	600	189
712-0602-22-100	600	450	PN10	600	135
712-0602-22-101	600	450	PN16	600	172
712-0603-22-100	600	400	PN10	600	133
712-0603-22-101	600	400	PN16	600	164
712-0604-22-100	600	350	PN10	600	120
712-0604-22-101	600	350	PN16	600	149
712-0605-22-100	600	300	PN10	600	113
712-0605-22-101	600	300	PN16	600	139
712-0606-22-100	600	250	PN10	600	106
712-0606-22-101	600	250	PN16	600	133
712-0607-22-100	600	200	PN10	600	100
712-0607-22-101	600	200	PN16	600	127
712-0608-22-100	600	150	PN10	600	95
712-0608-22-101	600	150	PN16	600	122
712-0609-22-100	600	125	PN10	600	93
712-0609-22-101	600	125	PN16	600	120
712-0610-22-100	600	100	PN10	600	91
712-0610-22-101	600	100	PN16	600	118